



Flat 44, The Moorings Stafford Street, Stone

£145,000 Leasehold



Second floor apartment which is accessible by the lift located near the front door. • Located in The Moorings retirement development right in Stone town centre • This property is ready for you to move straight in with no onward chain. • Stunning canal side communal gardens, which are beautiful landscaped and provide the perfect setting for residents • This apartment offers a lifestyle that combines convenience, charm, and natural beauty.



Come and experience the magic of a little country cottage feel within reach of town living, what more could you want from The Moorings? Prepare to be captivated by the charming open beams that adorn this beautifully designed living space. This second-floor one-bedroom apartment is the perfect place to relax and enjoy all that Stone has to offer just a stroll away. There is a lift by the front door, allowing easy access to take you upstairs to your humble abode. The large open-plan living and dining room provides versatile space for relaxing and entertaining guests. And a well-equipped kitchen with built-in cooking appliances ensures convenience and ease. A good size bathroom provides the option for a relaxing soak in the bath or walk-in shower and the double bedroom with built-in wardrobes offers plenty of storage space. At The Moorings, they offer more than a place just to live. The community mindset ensures that you have everything you need to enjoy your time there. Whether you want to catch up with friends in the communal lounge or host visitors, ample parking is provided and for those with overnight guests, there is a special suite to accommodate their stay. You can rest assured knowing that there is a secure door entry system, providing peace of mind and adding an extra layer of security. So, instead of just dreaming about it, take the leap and live a carefree life at The Moorings, call us today to make your dream a reality.



Charming one-bedroom apartment in Stone. Second-floor with lift access, spacious open-plan living area, well-equipped kitchen, large bathroom, and ample storage. With community lounge, parking and secure entry-Live carefree at The Moorings! Council Tax band: C

Tenure: Leasehold

EPC Energy Efficiency Rating: C

EPC Environmental Impact Rating: C



GROUND FLOOR

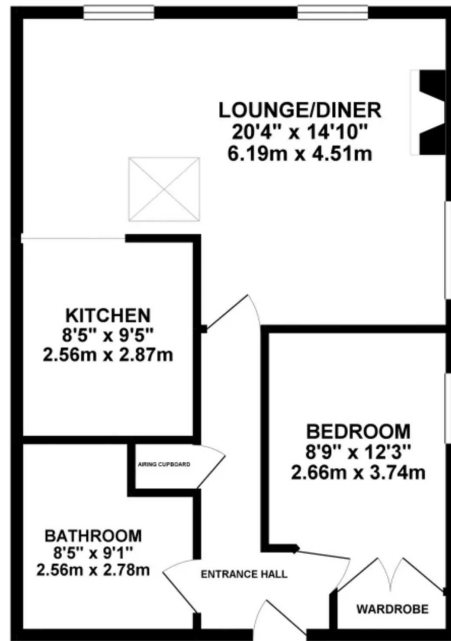

We have every effort been made to ensure the accuracy of the floorplan contained here. Measurements of doors, windows, rooms and any other items are approximate and no responsibility is taken for any error or omission in this statement. This plan is for illustrative purposes only and should be used as such by any prospective purchaser. The services, systems and appliances shown here have not been tested and no guarantee as to their operation or efficiency can be given.
Made with Metagon 8/2014

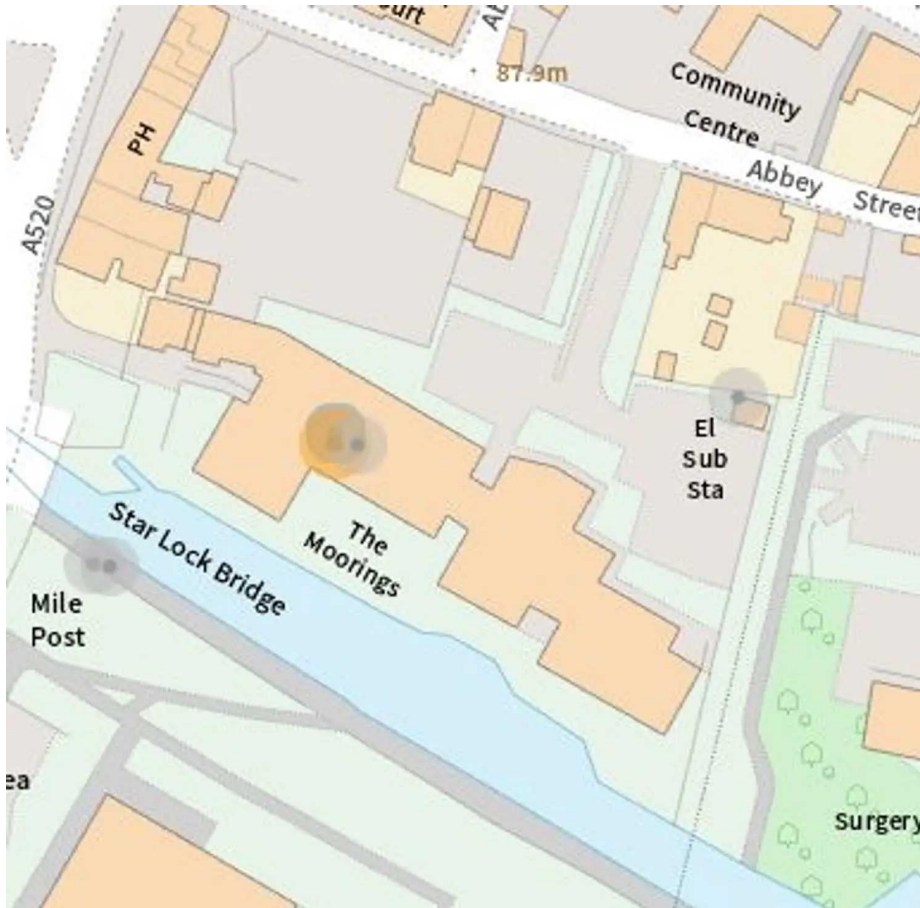

You can include any text here. The text can be modified upon generating your brochure.