

## 16 Reliant House Margaret Street, Stone

£185,000 Leasehold



Offered for sale with NO CHAIN • Two-bedroom, second floor good sized apartment in the heart of Stone. A corner position means natural light floods the open-plan living space. • A large storage cupboard and additional modern bathroom ensure there's plenty of space for everything. • One allocated parking space plus two visitor spots make having guests over easy and hassle-free. • Just a short stroll from Stone town centre and reliable commuter links, you'll have everything at your fingertips!





Reliant House, where you can truly rely on convenience and style! This spacious second-floor, two-bedroom corner apartment is as dependable as they come, offering both size and brightness in abundance. With its open plan living, dining, and kitchen area, you'll be greeted by natural light pouring through two Juliet balconies and an additional window, creating an airy, uplifting space you can always rely on for a sense of peace. The master bedroom is generously sized, complete with an en-suite shower room, while the second double bedroom offers flexibility for family, guests, or a home office. A modern bathroom and a large storage cupboard add to the apartment's practicality—you'll never be left wanting for space. Parking is never an issue with your own allocated spot and two additional visitor spaces, so having company is as easy as relying on the convenience of Reliant House. Let's not forget the location—you're just a hop, skip, and jump away from Stone's bustling town centre, with commuter links so reliable you'll never miss a beat. Call us today to arrange a viewing and experience the reliability of Reliant House for yourself!



2nd-floor 2-bed corner apartment with open plan living, Juliet balconies, en-suite master, modern bathroom, ample storage, and parking. Close to town centre and transportation links. CHAIN FREE!

Council Tax band: C

Tenure: Leasehold

EPC Energy Efficiency Rating: B

EPC Environmental Impact Rating:



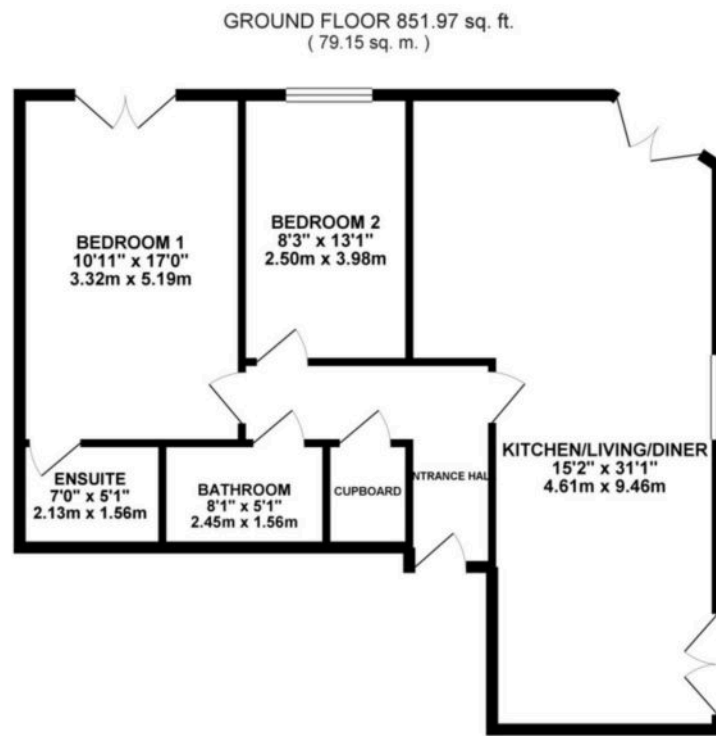

TOTAL FLOOR AREA: 851.97 sq. ft. ( 79.15 sq. m. ) approx.  
 Whilst every attempt has been made to ensure the accuracy of the floorplan contained herein, measurements of plots, buildings, rooms and any other items are approximate and no responsibility is taken for any error, omission or misstatement. This plan is for illustrative purposes only and should not be used as a basis for any prospective purchase. The format, layout and appearance of this plan may vary without notice and for guidance only. It is not intended to be a legal document. Made with iHomeplan 8.0.0.0

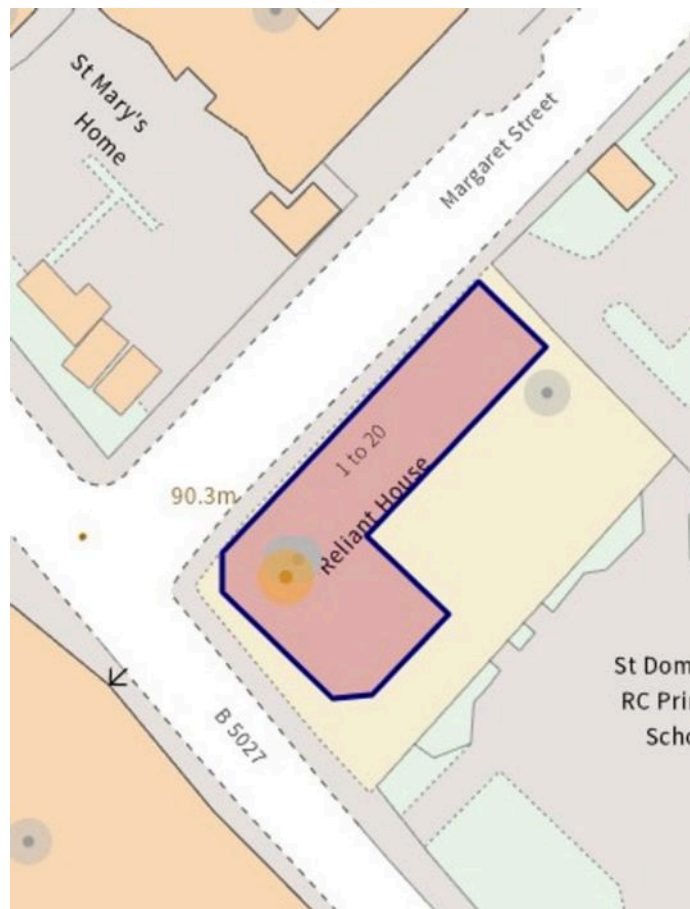

You can include any text here. The text can be modified upon generating your brochure.