



7 Market Fields, Eccleshall

£230,000 Freehold



A lovely three bedroom end of terrace home in Eccleshall awaiting its new owners. • On the first floor find three bedrooms and a family bathroom, ensuring there's room for everyone to relax and unwind. • A front porch, spacious living room and kitchen/diner makes the ground floor a treat. • Outside, enjoy a great sized rear garden along with a garage and ample side driveway for parking bliss. • Located in the heart of Eccleshall, enjoy excellent local amenities, schools and travel links, all just a few minutes walk away!



Wave your wand, cast your spell and let the magic unfold! Step into a world of wonder at this charming end-of-terrace home in Eccleshall. With three bedrooms and a bewitching blend of space and potential, this house is waiting for its next owner to wave their magic wand and add a personal touch. From the moment you park your broomstick on the driveway, you'll feel the spell of inspiration take over. Enter through a cosy porch, where the magic begins to swirl, leading you into the spacious living area. Picture yourself in front of the large window, the feature fireplace crackling away and the under-stairs cupboard ready to store all your mystical treasures. Next, we have the open-plan kitchen/diner, fitted with wood-effect cabinetry and complimenting work surfaces, a perfect cauldron for whipping up your favourite dishes. The room is ready for a dining set-up and those French doors out to the garden create an enchanting indoor-outdoor flow. Upstairs, you'll find three spellbinding bedrooms and a family bathroom. The master bedroom is a double delight with a built-in wardrobe to keep all your robes in order. The other two rooms are currently being used as a fabulous dressing room and a whimsical nursery, but are perfect for whichever enchanted space you wish to conjure. The family bathroom comes complete with a recently installed shower above the bath, a splash of magic for your daily routine! The garden is a realm of possibilities, with both a laid lawn and patio area waiting for your creative touch. The gate leads to the garage, offering extra convenience and with an extensive driveway running along then right side of the house, there's plenty of off-street parking for all your guests. The real magic lies in the potential, with so much space to the side of the home, your dreams are only limited by your imagination! Located in Eccleshall, you're surrounded by excellent local amenities, schools and transport links, all just a short walk away from this lovely home. So, what are you waiting for? Cast your spell, pick up the phone and call us to book a viewing, before this home disappears like a puff of smoke!



Charming 3-bed end terrace in Eccleshall. Entrance porch, spacious living area, open kitchen/diner, master with built-in wardrobe, newly fitted shower, rear garden, garage and driveway. Excellent local amenities and schools. Don't miss out, call to view!

Council Tax band: C

Tenure: Freehold

EPC Energy Efficiency Rating: C

EPC Environmental Impact Rating:



GARAGE 12.83 sq. m.
(138.14 sq. ft.)

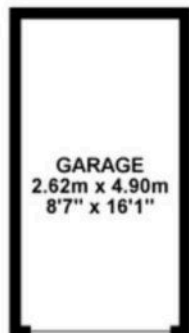

GROUND FLOOR 31.54 sq. m.
(339.51 sq. ft.)

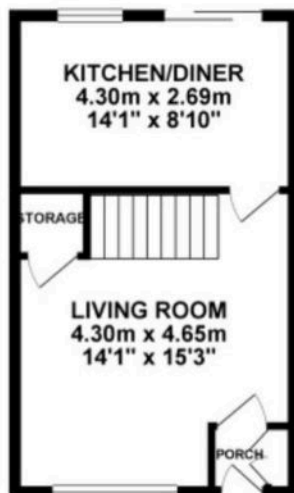

1ST FLOOR 30.77 sq. m.
(331.21 sq. ft.)

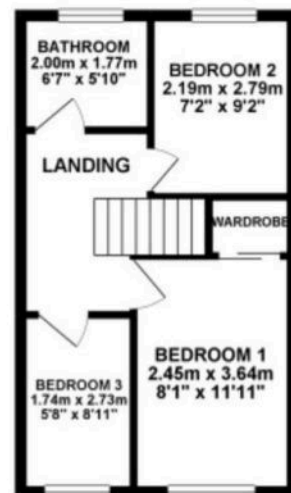

TOTAL FLOOR AREA : 75.14 sq. m. (808.85 sq. ft.) approx.

Whilst every attempt has been made to ensure the accuracy of the floorplan contained here, measurements of doors, windows, rooms and any other items are approximate and no responsibility is taken for any error, omission or mis-statement. This plan is for illustrative purposes only and should be used as such by any prospective purchaser. The services, systems and appliances shown have not been tested and no guarantee as to their operability or efficiency can be given.
Made with floorplan 80025



You can include any text here. The text can be modified upon generating your brochure.

01785 851886