



113 Tape Street, Cheadle

£139,950 Freehold

A cute terraced cottage located on Tape Street within walking distance to Cheadle town centre. • Having cosy living room with log burner and contemporary dining kitchen with modern bathroom found downstairs. • Two delightful bedrooms with storage to bedroom two, both are good sized doubles! • Outside is a pretty low maintenance courtyard with brick outbuildings. • With scenic walks on your doorstep, major commuter links close by and good amenities and schools.



Cute as a button! Pretty as a picture! This gorgeous and quaint cottage hone has plenty of character features and is beautifully presented ready for you to just pack your bags and move straight in! Stepping in through the front door the cosy living room greets you with a log burner set in a brick fireplace, flooding the room with warmth. A dining kitchen is fitted with cream shaker style cupboards and wood effect laminate worktops, we have plenty of space for a dining table and freestanding appliances. A modern bathroom is found off the kitchen and is fitted with contemporary marble effect tiles with shower over bath, WC and sink unit. Upstairs are two delightful bedrooms with storage cupboard to the second room. Outside is a pretty low maintenance courtyard with seating area and brick storage sheds. A perfect location being close to Cheadle town centre, with major commuter links close by and scenic walks on your doorstep. A great starter home or investment purchase, call to book your viewing now!



"Charming cottage with character features, log burner, modern kitchen & bathroom, 2 bedrooms, courtyard, close to town centre & commuter links. Ideal starter home or investment. Book viewing now!"

Council Tax band: A

Tenure: Freehold

EPC Energy Efficiency Rating: D

EPC Environmental Impact Rating: D



GROUND FLOOR
324 sq.ft. (30.1 sq.m.) approx.



1ST FLOOR
284 sq.ft. (26.4 sq.m.) approx.

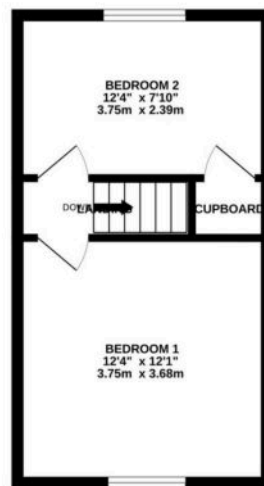

TOTAL FLOOR AREA: 608 sq.ft. (56.5 sq.m.) approx.
While every attempt has been made to ensure the accuracy of the floorplan contained herein, measurements of floors, walls, rooms and any other items are approximate and no responsibility is taken for any error appearing in the document. The plan is for illustrative purposes only and should not be used to rely on prospective purchaser. The services, systems and appliances shown have not been tested and no guarantee as to their operability or efficiency can be given.
Measure and reference 10/2025

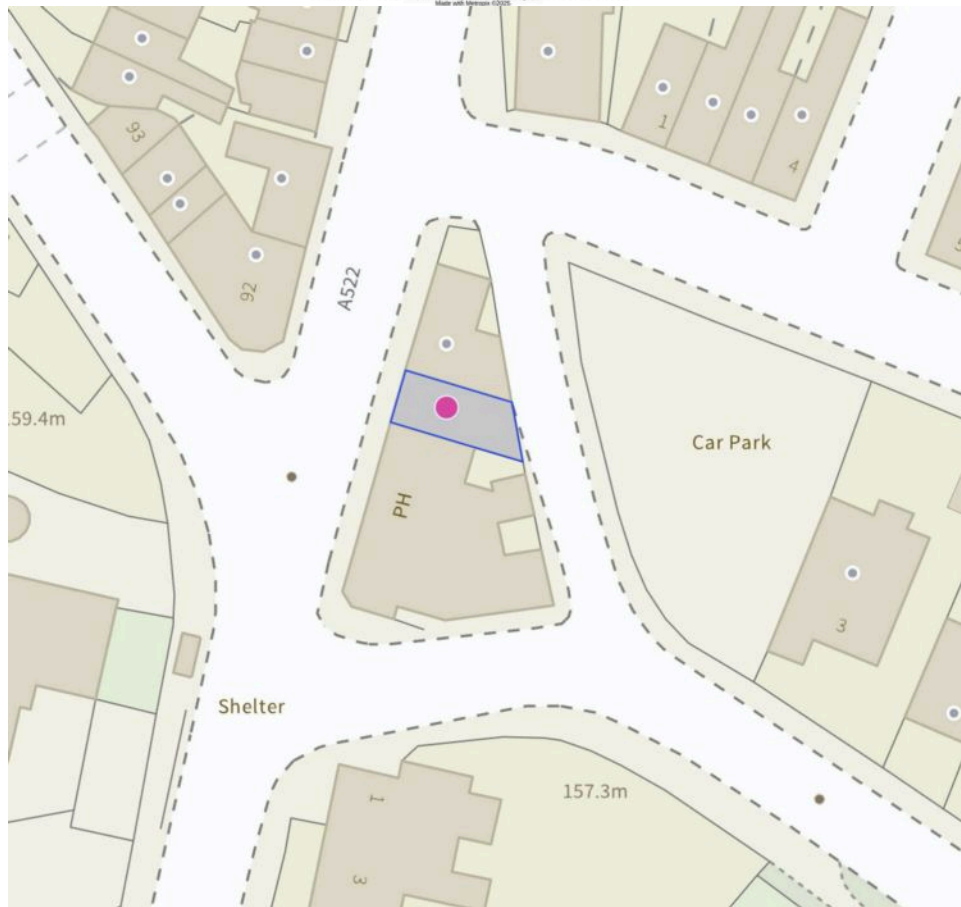

You can include any text here. The text can be modified upon generating your brochure.