



3 Trentwood Cottages Newcastle Road, Stone

£375,000



A beautifully finished two-bedroom cottage full of character with a modern twist, ready to move straight into.

- Set on an impressively large and private plot with multiple seating areas, lawns, a veg patch, and room to grow.
- A hidden gate at the top of the garden opens directly onto the peaceful canal towpath – perfect for walks and bike rides.
- Ample off-road parking plus a rare double garage, ideal for storage, hobbies or future conversion (STPP).
- With outbuildings, garden space and versatile interiors, there's plenty of room to extend or reimagine to your taste.



A modern cottage with a magical twist...All is not quite what it seems at Trentwood Cottages and trust us, the surprise waiting for you here is well worth the reveal. Tucked away behind this picture-perfect row of charming cottages lies a home that blends old-world character with a contemporary edge, creating the ultimate modern cottage dream. Once home to staff of the grand Darlaston Hall, this particular cottage has been transformed into a stylish, move-in ready retreat...all the warmth of a classic country cottage, with none of the hard work. Step inside and you'll find a welcoming entrance that opens into a cosy front lounge, complete with a log burner for those snug evenings in. There's handy open storage beneath the stairs, a smart nod to both form and function. Move through to the back of the property and you'll discover a sleek, well-appointed kitchen with integrated appliances, a deep pantry cupboard, and lovely views over the private courtyard garden. The adjoining dining room is light and airy thanks to skylights, and French doors draw you outside to the rear garden..just one of many outdoor spaces to enjoy. Practical touches continue with a separate utility room, space for appliances, and that all-important downstairs WC. Upstairs, you'll find two generous double bedrooms including a gorgeous principal suite with built-in wardrobes. The bathroom is beautifully finished too, featuring a contemporary walk-in shower, separate bathtub, and modern styling throughout. Outside is where this home really sets itself apart. The generous plot wraps around the cottage with thoughtfully designed seating areas throughout, perfect for chasing the sun from morning coffee in the courtyard, to afternoon tea on the decking, and sunset tipples at the top of the garden. There's a large lawn, vegetable patch, summerhouse, useful outbuildings, and even a double garage, all fully enclosed, making it ideal for children and pets. And the best part? A secret gate at the top of the garden leads you straight onto the canal towpath for Sunday strolls or peaceful evening walks. Set in a superb location with excellent commuter links, shops, and local amenities nearby, Trentwood Cottages offers more than meets the eye...a truly modern cottage with a story to tell and space to grow. Contact our Stone office today to arrange your viewing – this one really must be seen to be believed.



A charming modern cottage with a surprise twist! Stylish interiors, generous garden, canal access, parking & garage. Character meets contemporary – a must-see! Contact our Stone office today.

Council Tax band: TBD

EPC Energy Efficiency Rating: D

EPC Environmental Impact Rating: D



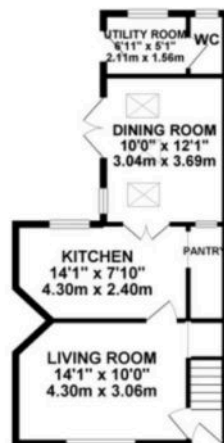
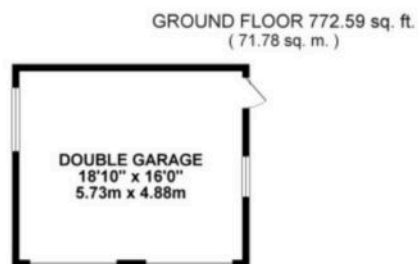

1ST FLOOR 298.75 sq. ft.
(27.75 sq. m.)

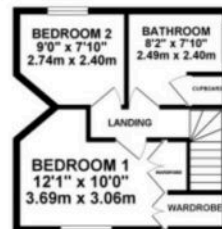

TOTAL FLOOR AREA - 1071.34 sq. ft. (99.53 sq. m.) approx.

Whilst every attempt has been made to ensure the accuracy of the floorplan contained here, measurements of doors, windows, rooms and any other items are approximate and no responsibility is taken for any error, omission or misstatement. This plan is for illustrative purposes only and should be used as a guide by any prospective purchaser. The services, systems and appliances shown have not been tested and no guarantee as to their availability or efficiency can be given. Made with iDesign 82025

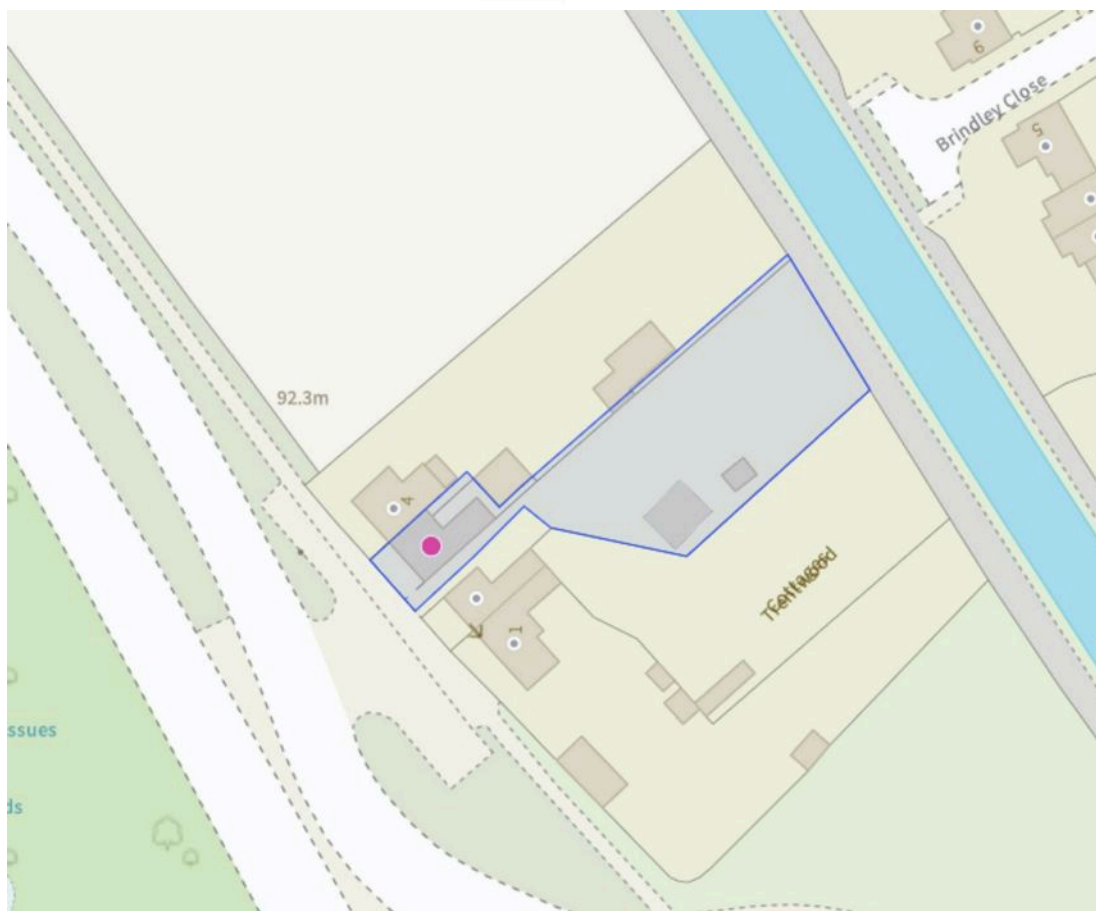

You can include any text here. The text can be modified upon generating your brochure.