



8 Rimini Close, Stoke-On-Trent

£285,000 Freehold



Three-bedroom family home, peacefully tucked away on a quiet cul-de-sac with a name that's just fun to say! • That multi-fuel log burner and stairway lights make evenings feel extra magical. • Stylish refitted kitchen, bathroom, flooring and heating system – all the hard work is done. • Loads of off-road parking and a huge garage, plus a low-maintenance garden to enjoy. • Within easy reach of local amenities, great schools together with bus and commuter links.



'Rimini, Rimini, Rimini roo, A home full of charm is waiting for you! Rimini Close, a quiet cul-de-sac treat, This three-bed delight is ever so neat!'

Tucked away in a peaceful spot in sought-after Meir Hay, this immaculate three-bedroom home is as lucky a find as you'll come across. Whether you're stepping onto the ladder for the first time, downsizing to something more manageable, or searching for that perfect family nest, this one ticks the boxes. Inside, the spacious living room welcomes you with a warm hug...light, airy, and centred around a multi-fuel log burner that crackles away beneath the soft glow of stairway lighting. Through to the kitchen, where generous storage and modern updates make cooking a pleasure. With a downstairs guest cloakroom, which has been thoughtfully converted. Venture further to the bright and versatile conservatory, a space that can flex to suit your lifestyle, be it dining, relaxing, or working from home. Upstairs, you'll find three bedrooms, two generous doubles with built-in wardrobe space, and a cosy third perfect as a nursery, home office, or guest room. The bathroom is fresh and modern, complete with a stylish 'P'-shaped bath and shower over. Outside, the current owners have transformed the driveway to provide ample parking, with smart gates leading to a large detached garage. A broad patio for summer barbecues and a raised AstroTurf area ideal for little ones or lounging. Not only has this home been lovingly updated with a replaced heating system, flooring, loft boarding and more, but it's also superbly located. Fancy a weekday or Sunday stroll then Parkhall Country Park is located only minutes away perfect for walking the dog or just getting back to nature. With excellent transport links, a super range of local shops providing everything for your daily needs and well-regarded schools nearby, you really couldn't ask for more.

'Rimini, Rimini, Rimini cheer,
A lucky new chapter is waiting right here!'



Rimini, Rimini, Rimini cheer – this immaculate 3-bed home is full of charm and modern updates, tucked in a quiet cul-de-sac with cosy vibes, parking galore, and a lucky feel throughout!
Council Tax band: C

Tenure: Freehold

EPC Energy Efficiency Rating: D

EPC Environmental Impact Rating: D



GROUND FLOOR 456.81 sq. ft.
(42.44 sq. m.)



1ST FLOOR 340.26 sq. ft.
(31.61 sq. m.)

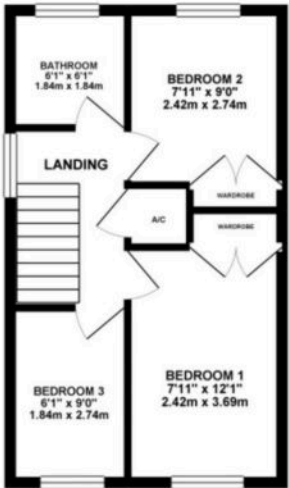

TOTAL FLOOR AREA : 797.07 sq. ft. (74.05 sq. m.) approx.

Whilst every attempt has been made to ensure the accuracy of the floorplan contained here, measurements of rooms, windows, doors and any other items are approximate and no responsibility is taken for any error, omission or misstatement. This plan is for illustrative purposes only and should be used as such by any prospective purchaser. The layout, colour and appearance shown here may not exactly reflect the actual property as to their quantity or efficiency can be given.
Made with CADPLAN 80000

GROUND FLOOR

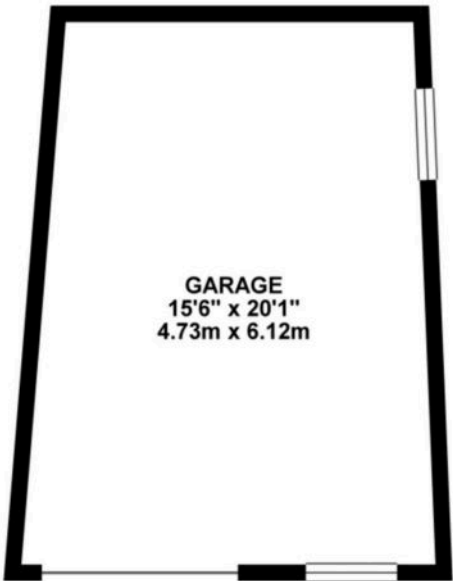

Whilst every attempt has been made to ensure the accuracy of the floorplan contained here, measurements of rooms, windows, doors and any other items are approximate and no responsibility is taken for any error, omission or misstatement. This plan is for illustrative purposes only and should be used as such by any prospective purchaser. The layout, colour and appearance shown here may not exactly reflect the actual property as to their quantity or efficiency can be given.
Made with CADPLAN 80000

You can include any text here. The text can be modified upon generating your brochure.