



8 Anthony Grove, Stoke-On-Trent

£245,000 Freehold



Beautifully maintained semi-detached bungalow offering two generously sized double bedrooms that are ideal for guests, hobbies or your own dressing room! Also offered for sale with NO CHAIN! • Spacious living room with picture window and feature fire surround, plus a lovely kitchen/diner in a practical L-shape with sleek cabinetry and plenty of space for appliances. • Stunning rear garden with patio seating space, lush grass lawns and mature hedging for peace and privacy. • Expansive driveway with off-road parking, pretty front garden with grass lawns and flowerbeds, plus access into a single garage for secure storage. • Ideally located near shops, supermarkets, eateries and healthcare services. Plus great commuter links via road, bus, and rail.



No stress, just YES!!! Tired of DIY dramas, renovation nightmares or climbing endless stairs? Say goodbye to stress and hello to the absolutely delightful, move-in-ready bungalow on Anthony Grove, perfectly planted in the heart of the warm and welcoming Meir Heath. Life here is all about ease – whether you're popping to the nearby shops, grabbing essentials from the supermarket, or sorting your health checkup down the road, everything you need is right here. Commuting is a breeze here with nearby bus routes, access to the A50, and Blythe Bridge train station down the road. Inside, you'll find a generously sized living room with a beautiful picture window and a charming feature fire surround for cosy nights in. The kitchen is set in a practical L-shape featuring sleek cabinetry, plenty of room for appliances and essentials, a dining space for hosting friends and family, plus a handy storage space for anything you want to hide from guests! Two generous double bedrooms offer comfy retreats, ideal for visitors, a hobby space or your own dressing room! The bathroom offers a bath/shower, sink, and W/C. Outside, the rear garden is a total retreat, well-maintained, with a lush lawn, patio seating space and mature hedging for peace and privacy. Out front, a further gorgeous garden, an expansive driveway with off-road parking, and a single garage! This beautiful home is being offered for sale with NO CHAIN meaning you can jump straight in to your forever home. So, if you're looking for comfort, convenience, and a whole lot of love – this is your sign. Book a viewing, bring your slippers and a brew, and prepare to fall in love.



Delightful move-in-ready 2 bungalow in Meir Heath, convenient access to shops, transport, and amenities. Spacious living, sleek kitchen, 2 bedrooms, lush garden, garage. No chain. Ideal for comfort and convenience. **NO CHAIN!** Council Tax band: C

Tenure: Freehold



GROUND FLOOR 824.38 sq. ft.
(76.59 sq. m.)

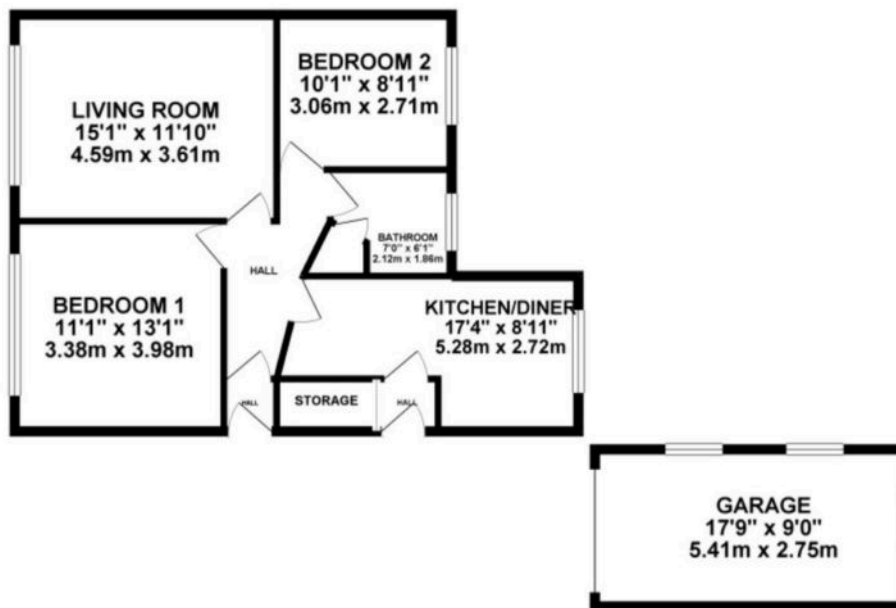

TOTAL FLOOR AREA : 824.38 sq. ft. (76.59 sq. m.) approx.

Whilst every attempt has been made to ensure the accuracy of the floorplan contained herein, measurements of doors, windows, rooms and any other items are approximate and no responsibility is taken for any error, omission or misstatement. This plan is for illustrative purposes only and should be used as such by any prospective purchaser. The services, systems and appliances shown have not been tested and no guarantee as to their operability or efficiency can be given.
Made with iFloorplan 02/02/25

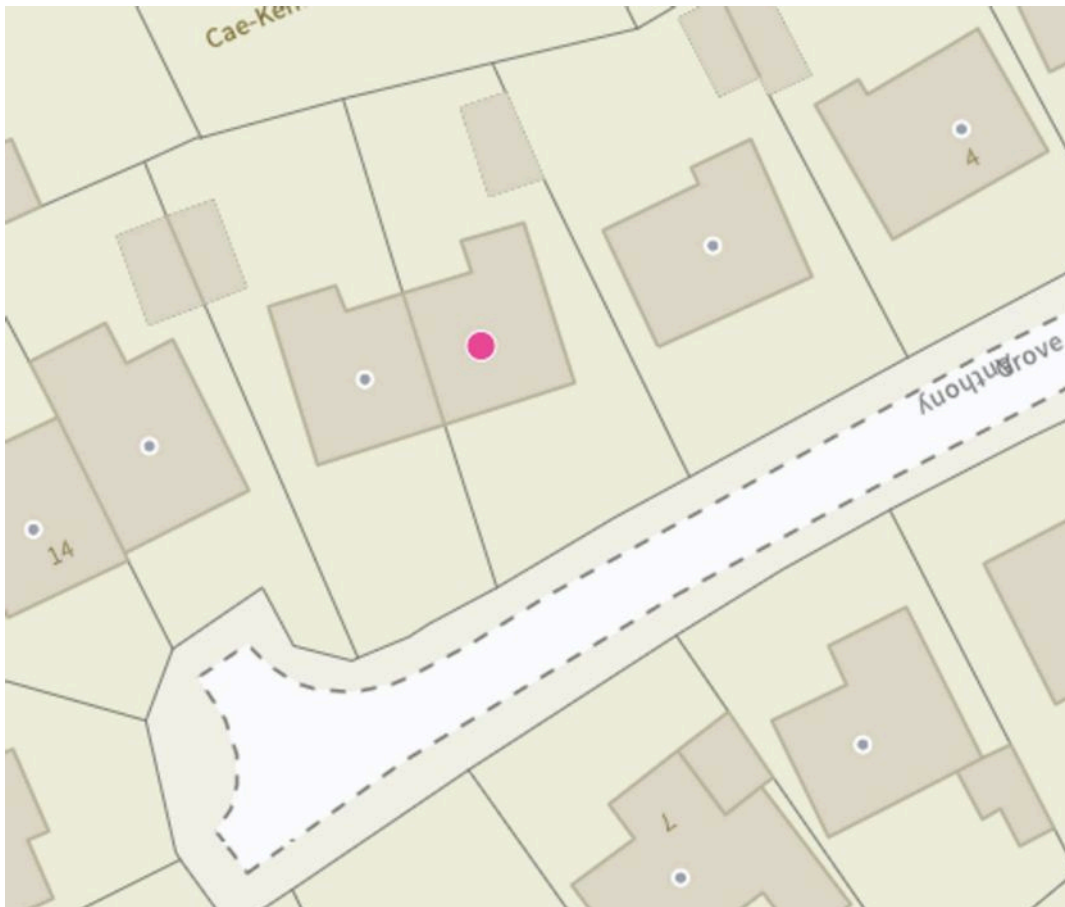

You can include any text here. The text can be modified upon generating your brochure.

01785 814917