



10 Lea Road, Stone

£285,000 Freehold



Detached bungalow offering two generously sized double bedrooms, a spacious attic room, plus a family bathroom with a bath/shower duo, sink, and W/C. • Bright lounge/diner, practical U-shaped kitchen, plus a further flexible reception room that could be ideal as a dressing room, home office or even a creative hobby room. • Generously sized rear garden with sunny patio seating space and lush grass lawns, the perfect spot for summer BBQs and weekend lounging. • The front of the home offers a generously sized driveway with off-road parking for several vehicles plus a single garage for secure storage. • Perfectly located in Walton near shops, healthcare services, eateries and Stone's busy centre. Amazing commuter links via bus, road, and rail.



L is for the way you look at me... And this beautiful two bedroom detached bungalow in Walton is sure to catch your eye – and your heart. From the moment you step in, you will feel the love woven into every corner of this warm and cosy home. Enter into a well-designed, U-shaped kitchen with sleek cabinetry, ample space for appliances and plenty of room for culinary creations. Continuing through into the open-plan living/dining room, it's an ideal space for curling up with loved ones or entertaining guests in true Come Dine With Me style. On the ground floor, discover two spacious double bedrooms, plus a flexible second reception space that could be a stylish dressing room, productive home office, or a creative home space. The bathroom features a bath/shower, sink, and W/C. Upstairs reveals a spacious attic room that is perfect for a little extra space, a creative hobby room or storage. Step outside to a generously sized rear garden with lush lawns and a sunny patio seating area, ideal for summer BBQs, weekend lounging or pottering about with plants. To the front is a driveway with ample off-road parking for several vehicles and a single garage for secure storage. Tucked away in Walton, you're conveniently close to shops, eateries, healthcare facilities and Stone's busy town centre. Commuters will appreciate the nearby bus routes, quick access to the A34 and the nearby Stone train station. So whether it's the way this home looks at you, the way it offers more than you've ever dreamed, or the way it simply feels like home, one thing's for sure... L is for the way you'll fall in love with it.



Love at first sight with this beautiful 3-bed bungalow in Walton. Stylish kitchen, open-plan living, 3 double bedrooms & flexible space on ground floor. Generous garden, garage, parking. Convenient location. Council Tax band: C

Tenure: Freehold



GROUND FLOOR 813.99 sq. ft.
(75.62 sq. m.)

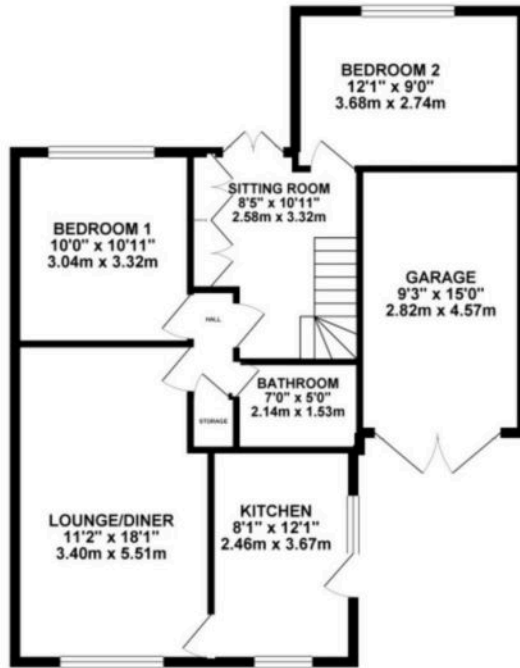

1ST FLOOR 173.93 sq. ft.
(16.16 sq. m.)

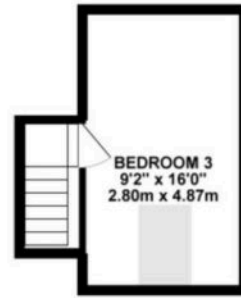

TOTAL FLOOR AREA: 987.92 sq. ft. (91.78 sq. m.) approx.

Whilst every attempt has been made to ensure the accuracy of the floorplan contained here, measurements of doors, windows, rooms and any other items are approximate and no responsibility is taken for any error, omission or misstatement. This plan is for illustrative purposes only and should be used as such by any prospective purchaser. The services, systems and appliances shown have not been tested and no guarantee as to their operability or efficiency can be given.
Made with Hologram B20225

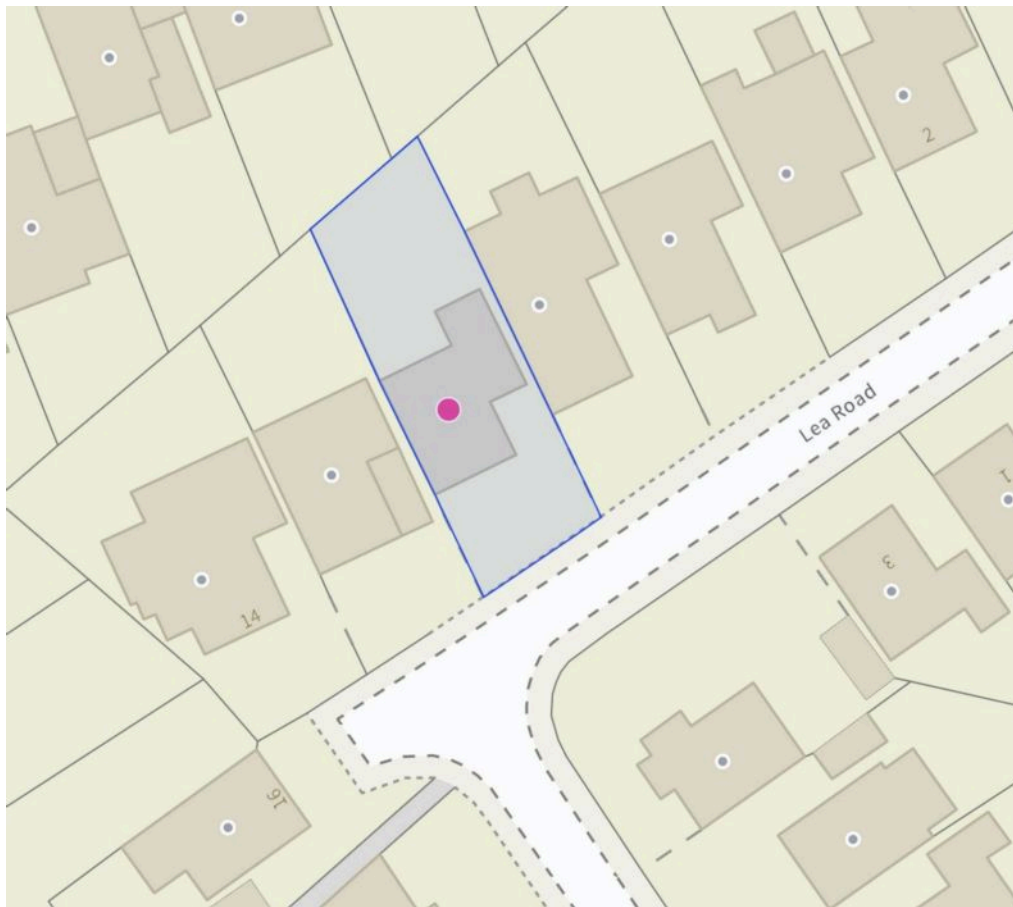

You can include any text here. The text can be modified upon generating your brochure.

01785 814917