

## 31 Price Close, Loggerheads

£290,000 Freehold



A charming bungalow in Loggerheads offering practical and comfortable living. • Two double bedrooms, one single bedroom/study and bathroom allows plenty of room to relax and unwind. • A spacious living room offers sliding doors out to the garden, a feature log burner and access into the kitchen. • Outside, enjoy a lovely garden with lawn, patio and array of botanical shrubbery to make your own. To the front a driveway and garage makes parking a breeze. • Located in Loggerheads, enjoy excellent local amenities and schools close by.





Like your favourite feel-good film, this charming bungalow is one you'll want to watch on repeat. A true home classic, it offers comfort, character and a plot twist of practicality with two large double bedrooms, a cosy third room and living spaces that deserve their own spotlight. As you roll up the driveway, you'll feel like the star of the show. Step through the front door and enter the hallway, where doors open like scene cuts to the living room, bathroom and bedrooms, setting the stage for your happily ever after. The living room is a spacious showstopper that features a statement log burner perfect for dramatic winter nights, plus sliding doors that reveal a garden backdrop. Through here, discover a stylish kitchen that's ready for your gourmet scenes, where glossy cabinetry, complimenting worktops and integrated appliances co-star in a space designed for both function and flair. Two generous doubles offer the perfect retreat after a long day on set. The third bedroom is an ideal supporting role, whether that be a snug single or home office ready for your next script. Fully tiled and dressed to impress, the bathroom features a walk-in shower, towel radiator, W.C. and sink. Step into your own private garden scene with a blend of patio, lawn and botanical shrubbery to get creative with. Gain garage access from both the garden and driveway, meaning you've got storage and parking covered in the director's cut. Set in the desirable location of Loggerheads, this home enjoys great local amenities and a Primary School close by. With Market Drayton, Eccleshall and Newcastle-under-Lyme just a short drive away for further needs. Call us today to book your exclusive viewing of this feel-good favourite. Don't let the credits roll just yet!



"Classic bungalow with 2 large bedrooms, spacious living room with log burner, modern kitchen, and stylish bathroom. Lovely rear garden, garage for storage, and excellent local amenities. Book a viewing today!"

Council Tax band: C

Tenure: Freehold

EPC Energy Efficiency Rating: B

EPC Environmental Impact Rating:





GROUND FLOOR 84.76 sq. m.  
( 912.35 sq. ft. )

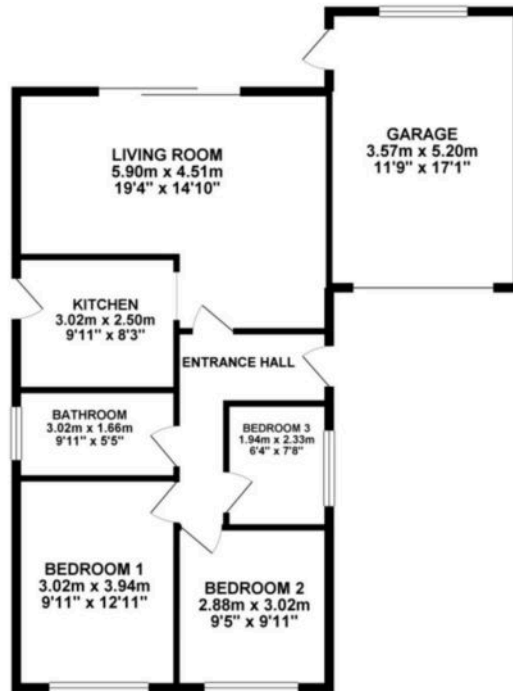

TOTAL FLOOR AREA : 84.76 sq. m. ( 912.35 sq. ft. ) approx.

While every effort has been made to ensure the accuracy of the floorplan contained herein, measurements of floors, windows, doors and any other items are approximate and no responsibility is taken for any error or omission of this document. This plan is for guidance purposes only and should be used in conjunction with the project's purchase. The survey, boundaries and dimensions shown here are not to be relied upon for any purpose other than that for which they are intended. Please refer to the project's purchase agreement for more details.



You can include any text here. The text can be modified upon generating your brochure.

01785 814917