



## 14 Barley Croft, Cheadle

£235,950 Freehold

Spacious two-bedroom semi-detached bungalow in sought-after Cheadle. • Low-maintenance garden with lovely views over the cricket pitch. • Generous living room with gas fire and bright conservatory to the rear. • Well-planned kitchen with wood-effect cabinetry and ample storage. • Large block-paved driveway, additional gated parking, and detached garage.



Overlooking the cricket green, this property knocks it out of the park! Tucked away in the ever-popular market town of Cheadle, this charming two-bedroom semi-detached bungalow offers a perfect blend of comfort and convenience. Step inside through a welcoming hallway into a spacious living room, complete with an gas fire and surround. The well-proportioned kitchen features wood-effect cabinetry, laminate worktops, and plenty of storage and preparation space. To the rear, a bright conservatory with tiled flooring provides an additional versatile living area and opens onto a low-maintenance garden with paving, neat planting, and delightful views across the cricket pitch beyond the boundary. A double bedroom with fitted wardrobes and second small double offer comfortable accommodation, served by a bathroom with a shower enclosure, WC, and basin. Externally, the property impresses with a large block-paved driveway and neat planting to the front, providing ample off-road parking, complemented by metal gates leading to further driveway space and a detached single garage with electric roller door and side access. Make your move and secure a home that's a true winner.





Charming 2-bed bungalow overlooking cricket green in Cheadle. Spacious living room, well-fitted kitchen, bright conservatory, low-maintenance garden, ample parking, detached garage.

Council Tax band: B

Tenure: Freehold

EPC Energy Efficiency Rating: D

EPC Environmental Impact Rating:



GROUND FLOOR 781.27 sq. ft.  
( 72.58 sq. m. )

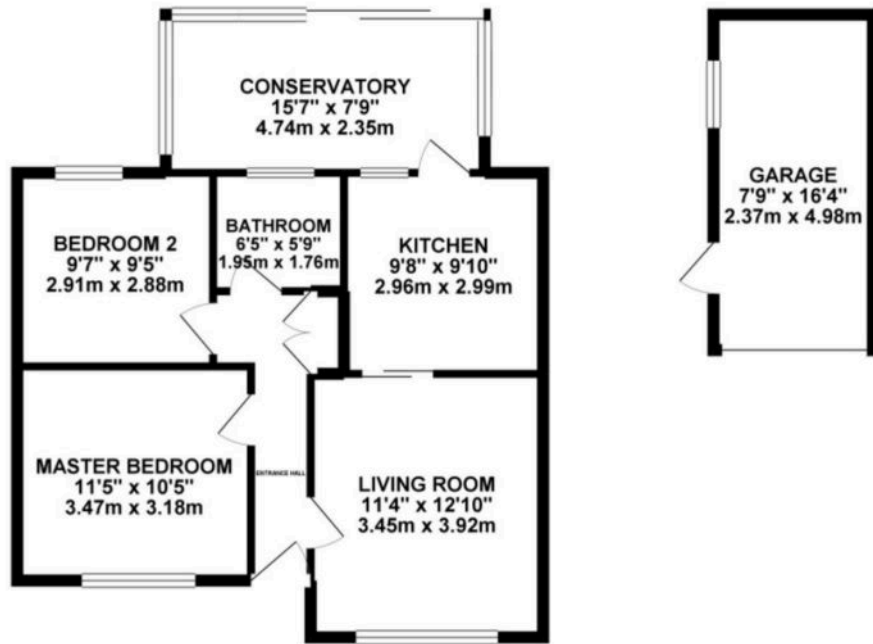

TOTAL FLOOR AREA: 781.27 sq. ft. ( 72.58 sq. m. ) approx.  
While every attempt has been made to ensure the accuracy of the floorplan contained here, measurements of doors, windows, rooms and any other items are approximate and no responsibility is taken for any error, omission or misstatement. This plan is for illustrative purposes only and should be used as such by any prospective purchaser. The various, systems and appliances shown have not been tested and no guarantee as to their operability or efficiency can be given.  
Made with H201001-02/21



You can include any text here. The text can be modified upon generating your brochure.