



100 Ness Grove, Cheadle

£215,000 Freehold

Prime location within walking distance of Cheadle, shops, schools and supermarkets, with excellent access to the A50 and wider commuter links. • Modern, spacious and well-equipped kitchen with ample storage and workspace • Contemporary bathroom with stylish fittings and double shower • Two comfortable double bedrooms with built-in storage • Welcoming entrance porch with practical storage



Your move to happiNESS begins here! A lovely two bedroom semi-detached bungalow in the market town of Cheadle. Enter into a light porch with space for coats and shoes, leading to a bright, spacious living room featuring a fireplace with a decorative surround. The hall connects to a good-sized kitchen fitted with modern white gloss wall and base units, laminate worktops, integrated gas hob, extractor fan, and a standalone tower housing an eye-level oven plus storage. Side access leads to the driveway and garden. Both double bedrooms have fitted sliding-door wardrobes, and the modern tiled bathroom includes a separate double curved shower enclosure, WC, bidet, and vanity basin unit with storage. Outside, the front garden is low maintenance with gravel and a picket fence, complemented by a large tarmac driveway leading to a detached single garage with an electric rollover door and side access. The rear garden is mainly lawn with paving, paths, a greenhouse, and a summerhouse. Located just a stone's throw from the market town of Cheadle where you will find a range of independent shops, markets and beautiful countryside walks. With great commuter links including a very useful bus route! Unlock your happiness at Ness Grove!



Charming 2-bed bungalow in Cheadle with a bright living room, modern kitchen, 2 double bedrooms, modern bathroom with double shower, large driveway, detached garage, and rear garden.

Council Tax band: B

Tenure: Freehold

EPC Energy Efficiency Rating: C

EPC Environmental Impact Rating:



GROUND FLOOR 846.88 sq. ft.
(78.68 sq. m.)

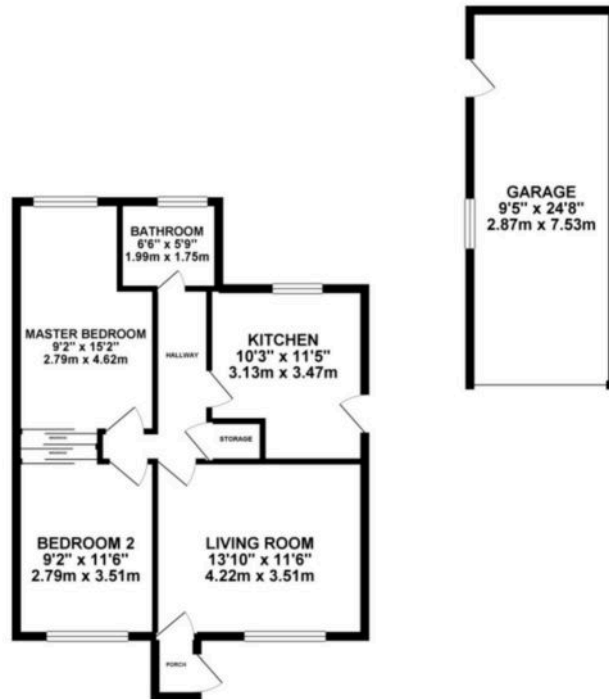

TOTAL FLOOR AREA: 846.88 sq. ft. (78.68 sq. m.) approx.

While every attempt has been made to ensure the accuracy of the floorplan contained herein, measurements of doors, windows, rooms and any other items are approximate and no responsibility is taken for any error, omission or misstatement. This plan is for illustrative purposes only and should be used as such by any prospective purchaser. The services, locations and quantities shown here are not intended to be guaranteed. See to the site plan, or otherwise, for the plan. Made with MapInfo 8.0.0.0.

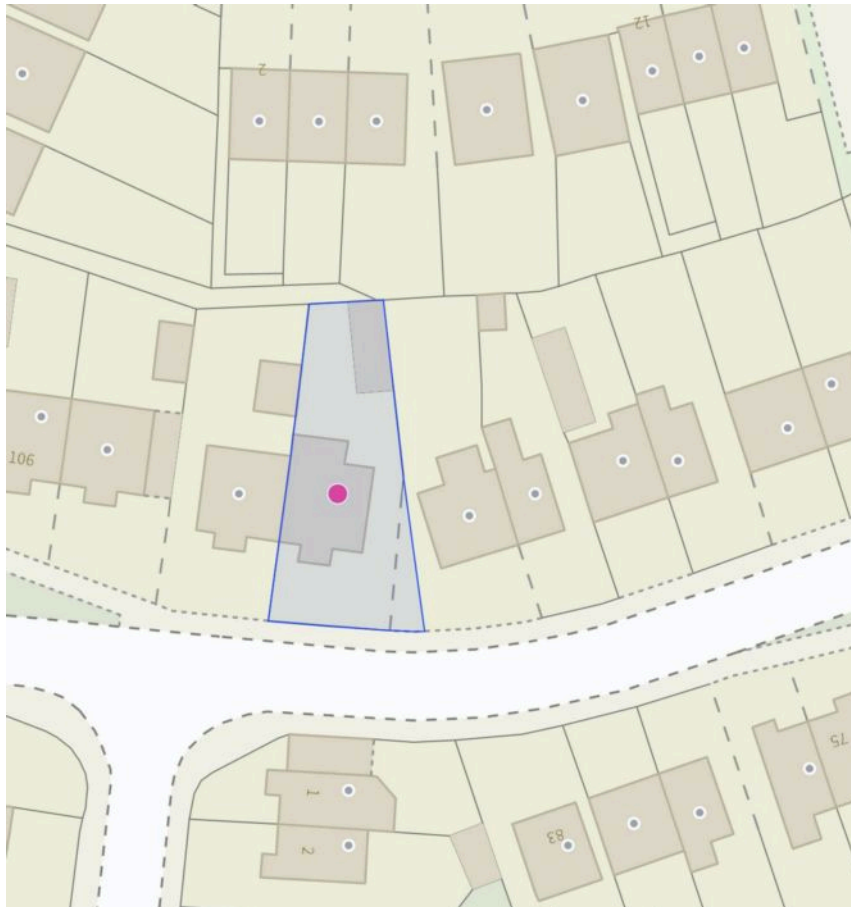

You can include any text here. The text can be modified upon generating your brochure.