



30 Bramley Close, Cheadle

£210,000 Freehold

in the heart of Cheadle town, this property offers a peaceful setting with green fields to the rear and a large park just down the road, ideal for families who love the outdoors. • A large driveway with room for multiple cars. • three well-proportioned bedrooms, two doubles and a versatile single that's ideal as a nursery, guest room, home office, or dressing room. • A fenced garden with the perfect blend of lush lawn and paved patio with handy outbuilding with electricity for extra storage • A spacious living and dining room. A newly updated modern kitchen, boiler, rear windows and roof.



Find Your Perfect Nest — Where Space Meets Location. Welcome to your ideal family home, where space, comfort, and convenience come together in perfect harmony. Nestled at the end of a quiet cul-de-sac in the heart of Cheadle town, this property offers a peaceful setting with green fields to the rear and a large park just down the road, ideal for families who love the outdoors. Step outside and you'll find yourself within easy reach of supermarkets, shops, pubs, and eateries, as well as an excellent selection of schools and transport links, including the A50, making daily life that much easier. As you arrive, a generous driveway welcomes you with space for multiple vehicles. Step inside through the entrance hall and to your left, discover a spacious living and dining room. With a bright bay window at the front and glazed sliding doors at the rear, this light-filled space is perfect for relaxing or entertaining. There's plenty of room for a large dining table and comfy furniture, ideal for family gatherings and cosy nights in. At the heart of the home is a sleek, recently updated kitchen featuring matte dark grey cabinetry, wood-effect worktops, and modern appliances, perfect for culinary adventures. The property also benefits from a recently replaced boiler and updated rear windows, offering peace of mind and energy efficiency. Downstairs is completed with clever under-stairs storage and a convenient guest WC. Upstairs, you'll find three well-proportioned bedrooms, two doubles and a versatile single that's ideal as a nursery, guest room, home office, or dressing room. A modern family bathroom completes the upper floor, fitted with a shower-over-bath combo. To the rear, enjoy a well-maintained garden, the perfect blend of lush lawn and paved patio, ideal for outdoor play, entertaining, or simply unwinding. A handy outbuilding with electricity offers extra storage or space for additional appliances. This home truly has it all, space, style, and a sought-after location. Whether you're upsizing, settling into family life, or simply looking for that perfect blend of comfort and convenience, this property ticks every box. Book your viewing today and take the first step toward making this beautiful house your new home.



Find Your Perfect Nest — Where Space Meets Location. Welcome to your ideal family home, where space, comfort, and convenience come together in perfect harmony
Council Tax band: B

Tenure: Freehold

EPC Energy Efficiency Rating: C

EPC Environmental Impact Rating: C



GROUND FLOOR 485.40 sq. ft.
(45.10 sq. m.)

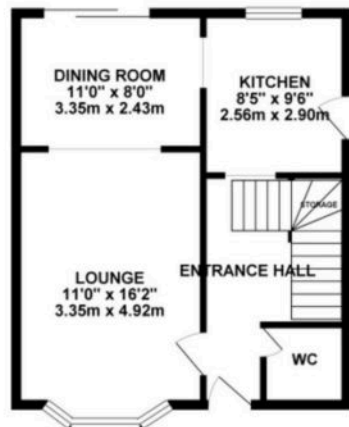

1ST FLOOR 486.04 sq. ft.
(45.15 sq. m.)

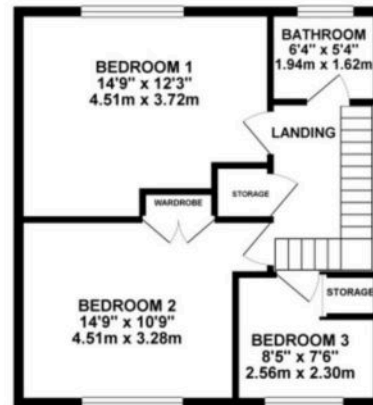

TOTAL FLOOR AREA: 971.44 sq. ft. (90.25 sq. m.) approx.

Whilst every attempt has been made to ensure the accuracy of the floorplan measurements, measurements of doors, windows, rooms and any other items are approximate and no responsibility is taken for any error, omission or misstatement. This plan is for illustrative purposes only and should be used as such by any prospective purchaser. The services, systems and appliances shown have not been tested and no guarantee is given to their operability or efficiency. See the plan.

Made with Ideagen 602021



You can include any text here. The text can be modified upon generating your brochure.