



11 Hilcote Gardens, Hilcote

£120,000 Freehold



A unique opportunity to be part of a private community of bungalows in a courtyard setting. • A perfect one bedroom bungalow with open plan living and dining room, kitchen and a bathroom. • Located in Eccleshall with a private garden, an allocated parking space and additional guest parking. • Additional communal gardens with seating areas and established plants trees and shrubs. • Set in the grounds of Hilcote Hall just a short tootle away from local amenities.



Treat yourself to a little slice of peace at Hilcote Gardens. This one bedroom bungalow is located on the outskirts of the pretty market town of Eccleshall and is set in the grounds of Hilcote Hall. The private development is made up of a handful of single level homes for the over 55's and provides a quiet alternative to the town. Enter into the hall way and into the property with a fully fitted kitchen with room for a small dining table, a full bathroom with over bath shower and on open plan living and dining room which leads out to the exterior. A private garden is yours to enjoy with a summer house for storage and additional communal gardens can be a place to converse with your lovely neighbours and pass the time. The property itself is ideal for a couple or a single person and provides independence and community. The town of Eccleshall is a very short distance away, more than walkable, with a plethora of bespoke independents shops, favourable watering holes, mouth watering restaurants and lovely walks.



One bedroom bungalow in tranquil Hildcote Gardens, Eccleshall. Set in over-55's community with peaceful surroundings, fitted kitchen, private garden, and close to amenities. Perfect for singles or couples seeking independence and community. Ideal location near town with boutique shops, restaurants, and scenic walks. Council Tax band: B

Tenure: Freehold

EPC Energy Efficiency Rating: D

EPC Environmental Impact Rating:



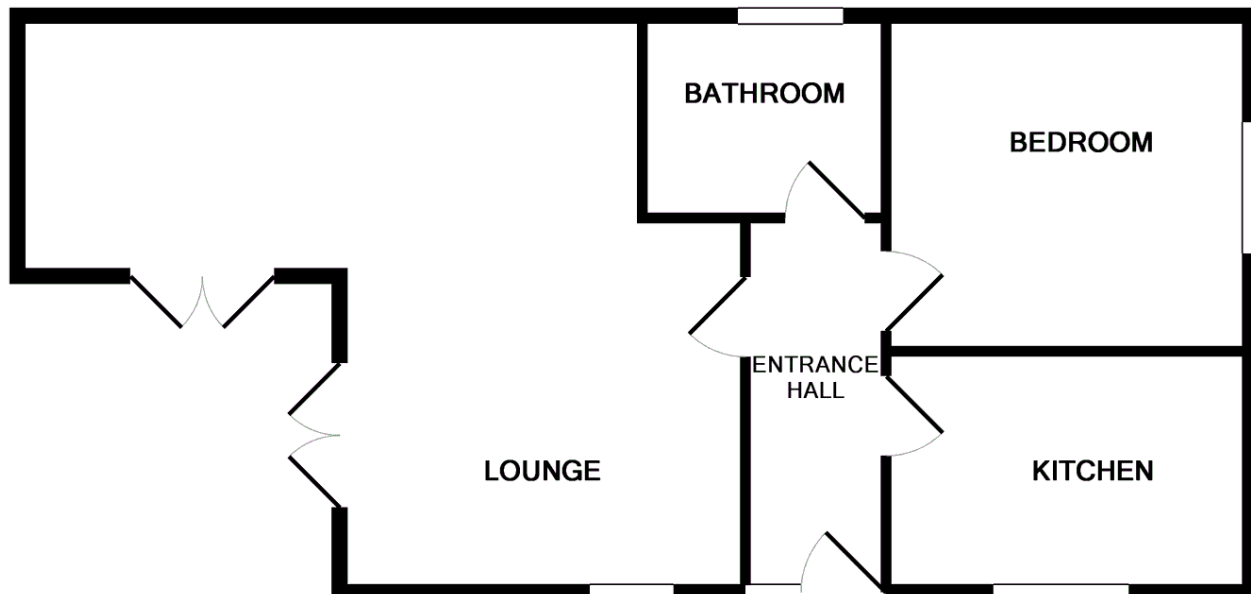

Whilst every attempt has been made to ensure the accuracy of the floor plan contained here, measurements of doors, windows, rooms and any other items are approximate and no responsibility is taken for any error, omission, or mis-statement. This plan is for illustrative purposes only and should be used as such by any prospective purchaser. The services, systems and appliances shown have not been tested and no guarantee as to their operability or efficiency can be given
 Made with Metropix ©2018



You can include any text here. The text can be modified upon generating your brochure.