



## Outlanes Croft Old Road, Oulton Heath

£725,000 Freehold



Charming Four bedroom detached bungalow with an annex and solar panels, ideal for downsizers and them seeking single-story, or multi-generational living. • Expansive living room and a cosy snug both with log burners, Sleek kitchen-diner with integrated appliances, and two light-filled conservatories, perfect for relaxing, dining, or entertaining. • Four versatile bedrooms, master bedroom with en-suite and two further bathrooms, each offering a bath and shower combination, vanity wash hand basin, and W/C. • Separate annex with, a bedroom, white kitchen with integrated appliances, shower room with shower, wash hand basin and wc.Plus an enchanting garden with stunning views and outdoor stores. • Close to Stone with charming cafés, shops, train station, and excellent transport links, offering convenience alongside scenic countryside views



Once upon a time...in the enchanted corner of Stone, there stood a charming four-bedroom detached bungalow, benefiting from solar panels, with a convenient annex, a secret waiting to be discovered. Perfect for those seeking a gentle single-story retreat, or a multi-generational happily-ever-after.

Cross the threshold and the tale begins in a grand living room, at the heart of the room, a log burner with traditional surrounds crackles softly. From here, a glazed sliding door opens into a bright conservatory, where the garden drifts inside.

At the very centre of this home lies the kitchen-diner, a place where morning tales are shared over tea. Sleek white cabinetry gleams, and worktops stretch wide. The kitchen is thoughtfully equipped with a double oven, microwave, electric hob, extractor fan, fridge, freezer, dishwasher, and a stainless steel sink with drainer, ensuring every meal is part of the adventure. From the sitting area, another glazed door leads to a second conservatory, a serene nook where the beauty of the garden becomes part of the story.

Nestled nearby, a snug awaits, with a large south-facing window that frames the scenery like a painted window in a castle tower. A log burner with traditional surrounds warms the room, creating the perfect retreat for curling up with a book.

The tale continues in the sleeping chambers, where four double bedrooms offer their own chapters. The master suite is complete with an en-suite featuring a bath and shower combination, a vanity wash hand basin, and a W/C. One of the other bedrooms, currently staged as a dining room, holds a delightful secret, an adjoining open dressing area with fitted wardrobes, ready to store treasures, hideaway stories, or prepare for the day ahead.

Two beautifully appointed bathrooms ensure that every moment of the day is met with comfort and charm. Each has a bath and shower combination, a vanity wash hand basin, and a W/C, offering a place to refresh and relax.

Adding to the magic are two generous storage areas, once humble coal stores, now ready to safeguard treasures. Just beyond the walls of the home lies a sheltered undercover store, a secret nook for garden tools or bicycles.

Step outside and discover a delightful garden, offering breathtaking views and the perfect setting for a spot of gardening or alfresco dining. Two separate concrete driveways lead through this enchanted setting, one to the main house, and one to the hidden jewel of the property, the annex.

Entering the annex is like opening a storybook of its own. A kitchen fitted with modern white cabinetry, contrasting worktops, and generous storage welcomes you. It is thoughtfully equipped with a four-burner gas hob, oven, microwave, fridge, and a stainless steel sink with drainer. A shower room, complete with a corner walk-in shower, pedestal wash hand basin, and W/C, adds both practicality and charm. Completing this magical space is a versatile room for guests or family, with glazed French doors spilling light into the room and opening to the garden.

## Location

Located on the outskirts of Stone and within easy walking distance of the town centre, Stone is a charming market





Once upon a time, in Stone, stood a detached 4 bedroom bungalow with an annex, living room, snug room, conservatories, kitchen/diner, plenty of storage areas, garden, and magical views offers a perfect single-story or multi-generational home. Ideal location Close to Stone with charming cafés, shops, train station, and excellent transport links, offering convenience alongside scenic countryside views.

Council Tax band: F

Tenure: Freehold



GROUND FLOOR 2837.76 sq. ft.  
( 263.64 sq. m. )

1ST FLOOR 0.00 sq. ft.  
( 0.00 sq. m. )

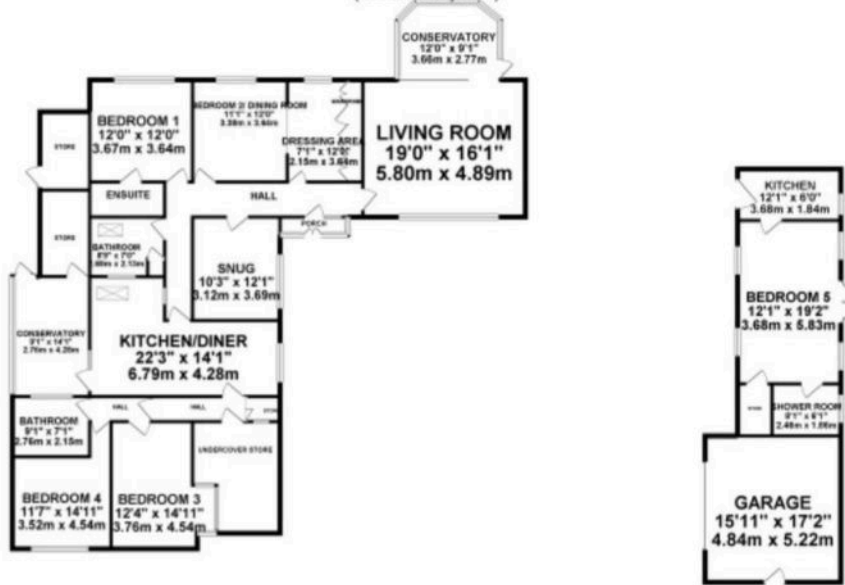

TOTAL FLOOR AREA : 2837.76 sq. ft. ( 263.64 sq. m. ) approx.

Whilst every attempt has been made to ensure the accuracy of the floorplan contained here, measurements of doors, windows, rooms and any other items are approximate and no responsibility is taken for any error, omission or mis-statement. This plan is for illustrative purposes only and should be used as such by any prospective purchaser. The services, systems and appliances shown have not been tested and no guarantee as to their operability or efficiency can be given.  
Made with Metropix ©2026

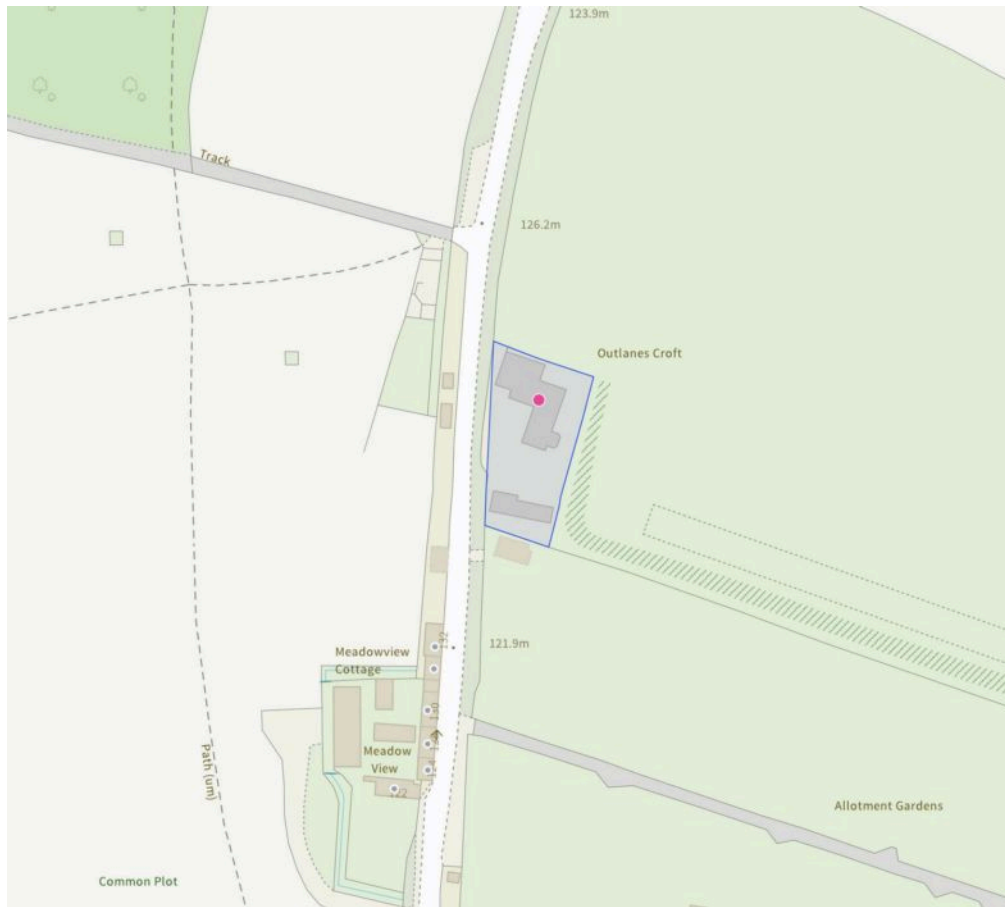

You can include any text here. The text can be modified upon generating your brochure.

01785 814917