



2 Harewood Close, Cheadle

£700,000 Freehold

A love nest with breathtaking views! This spacious four-bedroom home offers a dreamy setting, where every window frames a view you'll fall for again and again. • Your own private romantic retreat! With a lush South-West facing garden and 2.17 acres of garden and woodland, it's a secluded sanctuary, perfect for quiet moments and long walks together. • Light-filled spaces to fall in love with expansive windows and a glass-fronted hallway flood the home with natural light, creating a warm, uplifting atmosphere. • Room to share life's special moments from the elegant lounge/diner to the cosy conservatory, every space invites connection, relaxation, and making memories. • A welcoming arrival, every time. With sweeping driveway and double garage set the stage for that "coming home" feeling one you'll cherish day after day.



"At last. My love has come along. My lonely days are over. And life is like a song," you're picturing it now, aren't you, the moment you open your brand new house for the first time, proudly overlooking striking views as far as the eye can see, proud as punch with your new spacious abode. Boasting 2.17 acres of land as well as a spacious and secluded four-bedroom home, it's a love match you have been waiting for. Park up on the large sweeping white stone driveway or make use of the lower level double garage, and once arrived, you won't want to leave. From the garage is a storage room, which could easily be converted to an office, playroom or workshop. A little updating here and there could elevate it to whole new levels with scope to even extend or build (subject to necessary planning permissions). Enter the spacious glass fronted hallway (glass fronted large windows are a well thought out theme throughout this home) to your right, a huge dual aspect living dining room spanning the width of the home. Tall full-length windows frame the views perfectly, no cinema needed, as here, you have the best picture from your very own home. From here to the left, you have the breakfast kitchen. An abundance of wooden cabinets for all your storage needs as well as room for a breakfast table for morning fry-ups or a croissant and coffee. A utility joins the kitchen for additional storage and room for appliances. How does the saying go, out of sight, out of mind? Need another reception room to relax and unwind? A sunny conservatory sits on the back of the property, allowing you to bask in natural light with your favourite tipples surrounded by garden and woodland views. Downstairs is complete with a shower room, with a storage cupboard to help keep all your belongings tidied away. Upstairs, the property boasts four double bedrooms with a beautiful view from every window. A family bathroom completes the floor with both a separate bath and a walk-in shower. To the rear, you have a South West facing garden with large lush green lawn as well as a patio seating area trimmed with flowers, trees and plants, bringing it all to life. Beyond the garden lies extensive woodland, creating a peaceful and private setting. Accessed via a garden gate, it offers the perfect spot for a quiet stroll and a chance to enjoy the surrounding nature.. All this beautiful home and land is located on the outskirts of Cheadle, a market town in the Staffordshire Moorlands. Boasting well-regarded schools, an array of everyday modern conveniences, and beautiful scenery all around. For transport, strong access to the A50 and regular bus routes make light work of getting further afield. Think this home calls to you as your future love match? Book your viewing today to truly experience the magic of this wonderful home.



"At last. My love has come along. My lonely days are over. And life is like a song," picture it now, the moment you open the front door, overlooking striking views sitting on 2.17 acres of land.
Council Tax band: F

Tenure: Freehold

EPC Energy Efficiency Rating: D

EPC Environmental Impact Rating:



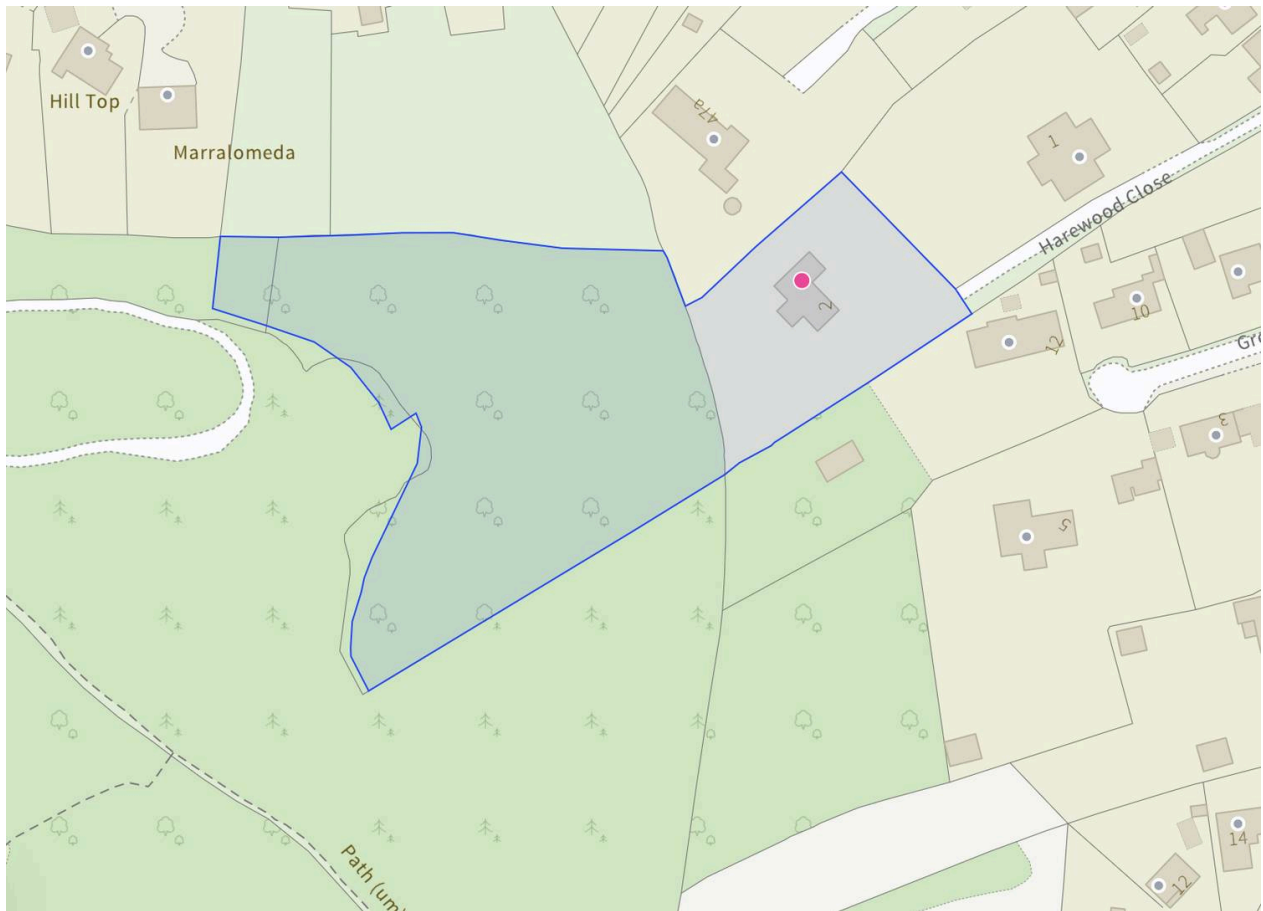
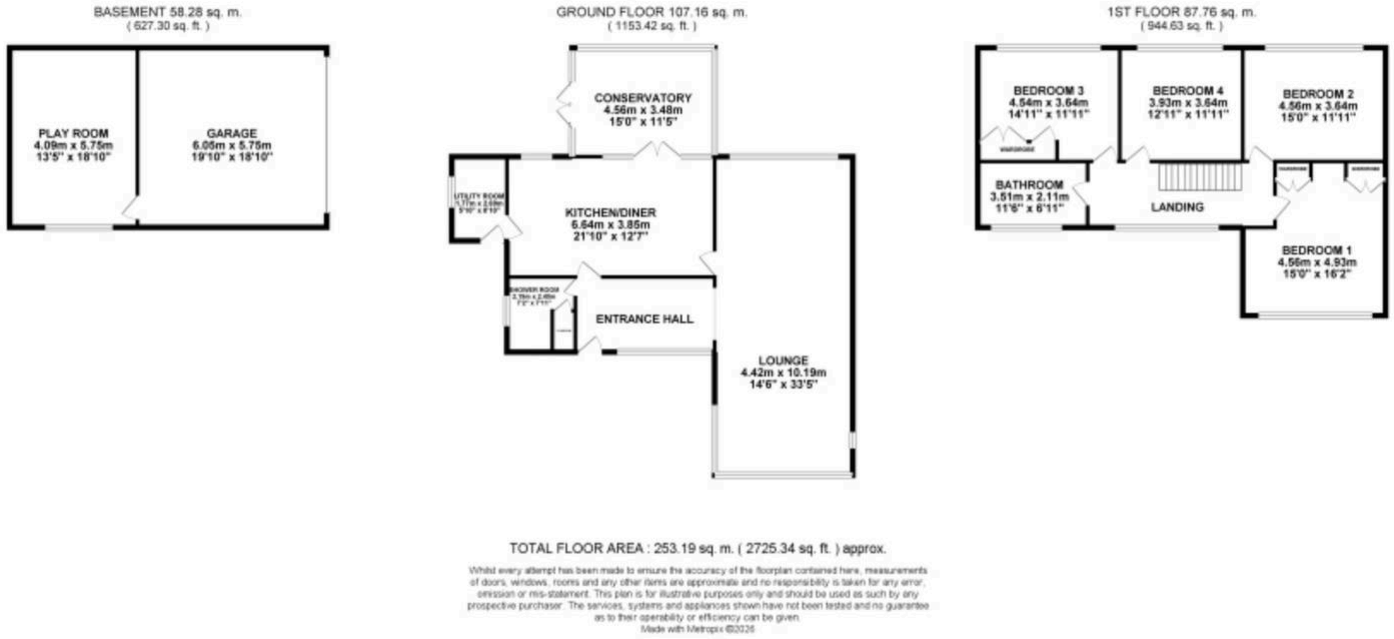

You can include any text here. The text can be modified upon generating your brochure.